

LEGEND	
	DRUM
	CONSTRUCTION SIGN
	TYPE III BARRICADE
	UNDER CONSTRUCTION
	COMPLETED CONSTRUCTION
	DIRECTION OF TRAFFIC ARROW
	PORT. CONCRETE MEDIAN BARRIER (P.C.M.B.)
	TEMP. IMPACT ATTENUATOR
	ARROW BOARD

- NOTE:
- CONSTRUCTION SIGNS SHALL BE VISIBLE ONLY WHEN ACTIVITIES WARRANT. TO BE COVERED OR REMOVED WHEN NOT IN USE.
 - EXISTING SIGNS THAT WOULD INTERFERE WITH CONSTRUCTION ZONE SIGNING SHALL BE REMOVED OR COVERED.
 - ANY EXISTING CONFLICTING STRIPING SHALL BE REMOVED PRIOR TO SHIFTING TRAFFIC.
 - DIRECTIVES FROM STANDARD PDT-1 "PAVEMENT DROP-OFF TREATMENTS" SHALL BE FOLLOWED AT ALL TIMES.
 - (1) W1-8 SHALL BE PLACED ON EVERY OTHER DRUM THRU LANE TAPERS. (1) R4-7A(R) OR (1) R4-7A(L) (AS APPLIES) SHALL BE PLACED ON EVERY OTHER DRUM THRU TANGENT LANES. THE ENDS OF THE PORTABLE CONCRETE MEDIAN BARRIER MUST EITHER BE FLARED TO OUTSIDE OF CLEAR ZONE (PER AASHTO ROADSIDE DESIGN GUIDE LATEST EDITION) OR PROTECTED BY A ODOT APPROVED ATTENUATOR AT ALL TIMES.
 - GUIDELINES FROM THE 2009 MUTCD SHALL GOVERN.

PHASE 2 - RAMP A CONSTRUCTION:
 REMOVE TEMPORARY SOUTHBOUND OFF RAMP PAVEMENT.
 ACCESS TO EXISTING SOUTHBOUND ON RAMP TO REMAIN OPEN THROUGH STAGED CONSTRUCTION OF RAMP A.

STAGE 3:
 SHIFT SOUTHBOUND ON RAMP TRAFFIC TO NEWLY CONSTRUCTED RAMP A PAVEMENT. REMOVE TEMPORARY SOUTHBOUND ON RAMP PAVEMENT.

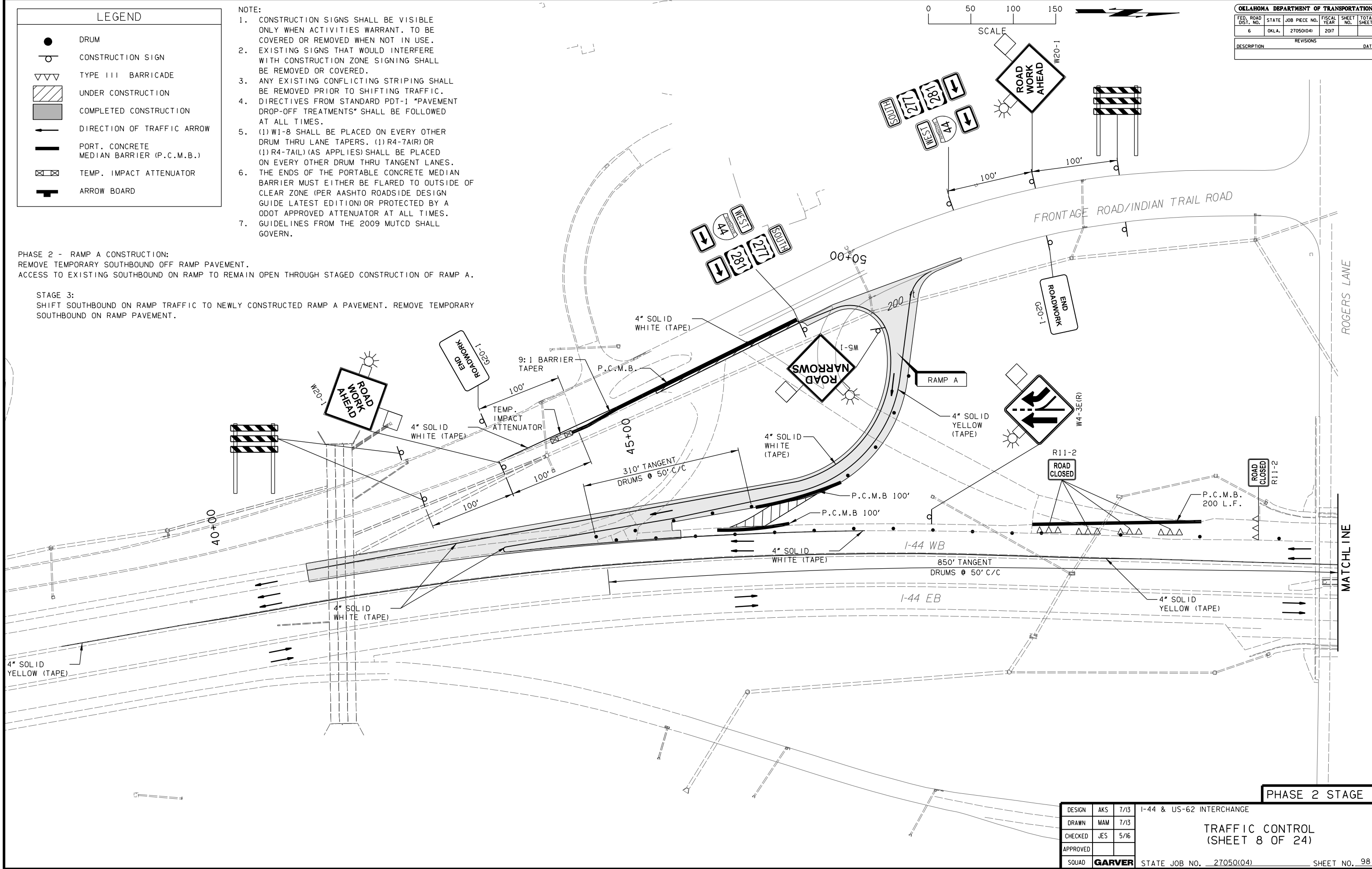

PHASE 2 STAGE 3

DESIGN	AKS	7/13	I-44 & US-62 INTERCHANGE
DRAWN	MAM	7/13	
CHECKED	JES	5/16	
APPROVED			
SQUAD	GARVER	STATE JOB NO. 27050(04)	SHEET NO. 98

TRAFFIC CONTROL
 (SHEET 8 OF 24)